

**DESIGN
TALKS
&
DEGREE
SHOW**

PROGRAMME

MAY 30-31

UMEÅ SWEDEN

Welcome

UID23 | Design Talks & Degree Show is the annual celebration of the commitment, talent and knowledge that exists here at the Umeå Institute of Design. Once again, our grad show represents a manifestation of the strong values we hold, based around collaboration, people and our planet. External guests from the field, along with other strategic connections, will join us to witness our students' innovative work that stretches the limits of creativity and imagination.

This year, our students have embarked on a transformative journey, exploring the boundaries of sustainability and design as a responsible practice. With great pride, we unveil their ingenious proposals and profound perspectives on tackling the difficult challenges facing our modern society. Graduating students from product-, interaction- and transportation design have prepared to express their journeys leading up to the show.

Welcome to two days of inspiration, relevant discussions, and many networking opportunities. Enjoy!

Demian Horst

Head of Department

Programme Overview

Tuesday May 30

- 9:00 Pre-scheduled interviews
- 11:30 Registration & light meal
- 13:00 Opening words
- 13:15 TALKS: PART 1
- 14:15 Coffee break
- 15:00 TALKS: PART 2
- 16:00 Break
- 16:30 TALKS: PART 3
- 17:30 Golden Seed Awards announcement
- 18:15 Dinner
- 19:15 EXHIBITION OPENING

Wednesday May 31

- 10:00 Opening words
- 10:10 KEYNOTE 1 – Beno Juarez
- 10:30 KEYNOTE 2 – Diana Africano Clark
- 10:50 Coffee break
- 11:20 PANEL DISCUSSION
- 11:55 Closing words
- 12:15 Light meal & unveiling of the ‘Plant Wall’
- 12:45 Pre-scheduled interviews

Talks Programme Tuesday May 30

13:15 DESIGN TALKS : **PART 1**

BFA LYDIA BÄCKSTRÖM

Vindel

The future of exploring nature: improve safety and reduce your vulnerability out in nature.

APD LAURENZ SIMONIS

Collaborative care

Exploring the potential of mobile, collaborative robots in relieving health care staff.

IXD JAN VON LOEPER

Nectar

Implicit interaction as a sixth sense for exploring cityscapes and recording the soundtrack of your life.

TD HEIDI YLI-SUVANTO

By - The Social Ferry

Encouraging social connections in a new community through a public transportation service.

APD YUCHEN LAN

Cystic fibrosis

Improving adherence to 'Airway Clearance Therapy' in adolescent cystic fibrosis patients.

IXD ANNA PUCHALSKA

Solar literacy

Exploring futures of environmentally-aware digital experiences for fossil free internet.

Talks Programme Tuesday May 30

DESIGN TALKS : **PART 1** (continued)

TD CHRISTOFFER WEINREICH

NIO Homi

Bridging the gap between small living spaces and mobility for young families in the future urban space.

BFA ISABELLE OLSSON

Quiet space

Creating a space where you can focus on your work, in quiet.

APD STIJN VAN CUIJK

Jabra Assist

Improving patient outcomes in emergency care through advanced communication technology.

IXD CORNELIA HULLING

Collective anticipation

Engaging with shared expectations of future life and mobility around the long making of a train line.

TD MARIUS CRAMER

Toyota Eco Warrior 2037

Exploring how highly sustainable communities will live, what their demands on a vehicle in 2037 will be.

Talks Programme Tuesday May 30

15:00 DESIGN TALKS : **PART 2**

BFA ISAAC STENEGÄRD

Coralconnect

An experience of the ocean in a responsible and educating way.

APD YILIN LYU

ENLINK

Digitizing small-scale agriculture for a sustainable and productive future.

IXD KIMBERLEY BEAUPREZ

Carefree in 2060

A look into how systems, needs and emotions interplay when imagining retirement in the future.

TD FEDERICO KAKAZU

Patagonia Explora

Exploring remote locations and landscapes in Patagonia through scientific tourism.

BFA JOSEPHINE SAMUELSSON WAHL

Dangers beneath the surface

Solving pollution wrecks from WWII posing a danger to our environment.

IXD LINDA KRAFT

Expressive Signals

The art of connecting: Enhancing digital expression through crafted connectivity and microinteractions.

Talks Programme Tuesday May 30

DESIGN TALKS : **PART 2** (continued)

BFA RUBEN PRESUN

Future transport of timber

A new way of transporting timber in forests without leaving any damages.

TD WENYU WU

MINI URBMAN: Slow City

A vehicle that co-exists with pedestrians enhancing urban vitality in a future slow city.

BFA JOHAN HÖIJERTZ

Care & Repair

Simplified repair kit to extend garment lifespan.

APD JAKOB KOHNLE

Flir System-X

Lowering the barriers of thermal imaging to enable new use cases.

BFA IVER ALEXEY ZAITZOW MIKAELSEN

Modular boat interior

One hull made to match a wider range of owners for a longer time.

IXD ALEXANDER WIDUA

MaterialKit

Exploring digital materials that bring more of the world around us back to the interfaces in front of us.

Talks Programme Tuesday May 30

16:30 DESIGN TALKS : **PART 3**

APD JOVAN VULIC

Crisis obstetrics

Exploring training solutions for midwifery in refugee camps.

IXD DONGHENG WU

Living sparks

Exploring spatial interactions that shape “Vujà Dé” in confined living spaces to enhance well-being.

BFA MOHAMMAD HAJJO

Safe homes

Prevent and predict fall accidents among the elderly, for independency and a better quality of life.

TD SAIF AL KHAMISSI

Velaria

Investigating the value of shared mobility in future megacities.

BFA MÅRTEN MALMNÄS

Plate Pal

Should a diet be based around the food on the plate or by the person eating it?

IXD RUOYUN WANG

Empathy in digital communication

A design exploration into daily interpersonal communication through digital mediated technology.

Talks Programme Tuesday May 30

DESIGN TALKS : **PART 3** (continued)

TD ERIK OLSSON

Hyper Abilities

Communicating hidden information of the natural world through the senses while traveling.

IXD HYUNJIN SHIN

Enhancing emotional intelligence

Enhancing emotional intelligence to have more positive emotion at online workplace.

APD MARIAN DEMBKIEWICZ

XTR 10K

Reimagining and designing the future of multi-purpose workwear.

TD ZAIN KADRI

Aquapod

A holistic approach towards marine life exploration and ocean awareness.

IXD AMANDA WALLGREN

Choreographic interfaces

Encourage and elevate personal movement languages in conversation with digital devices at home.

Finding your way around UID:

Entrance Floor (0)

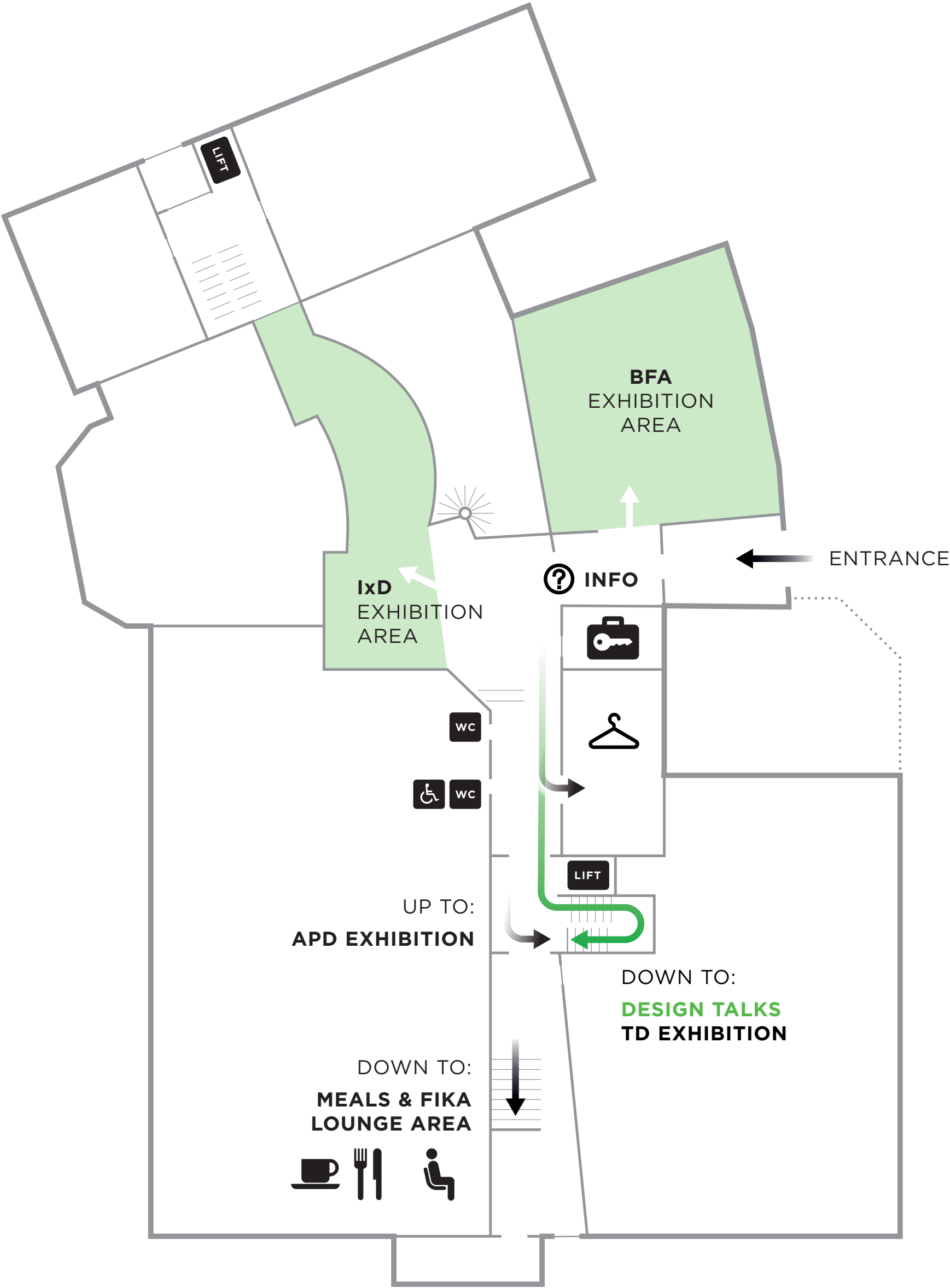

Finding your way around UID

Basement Floor (-1)

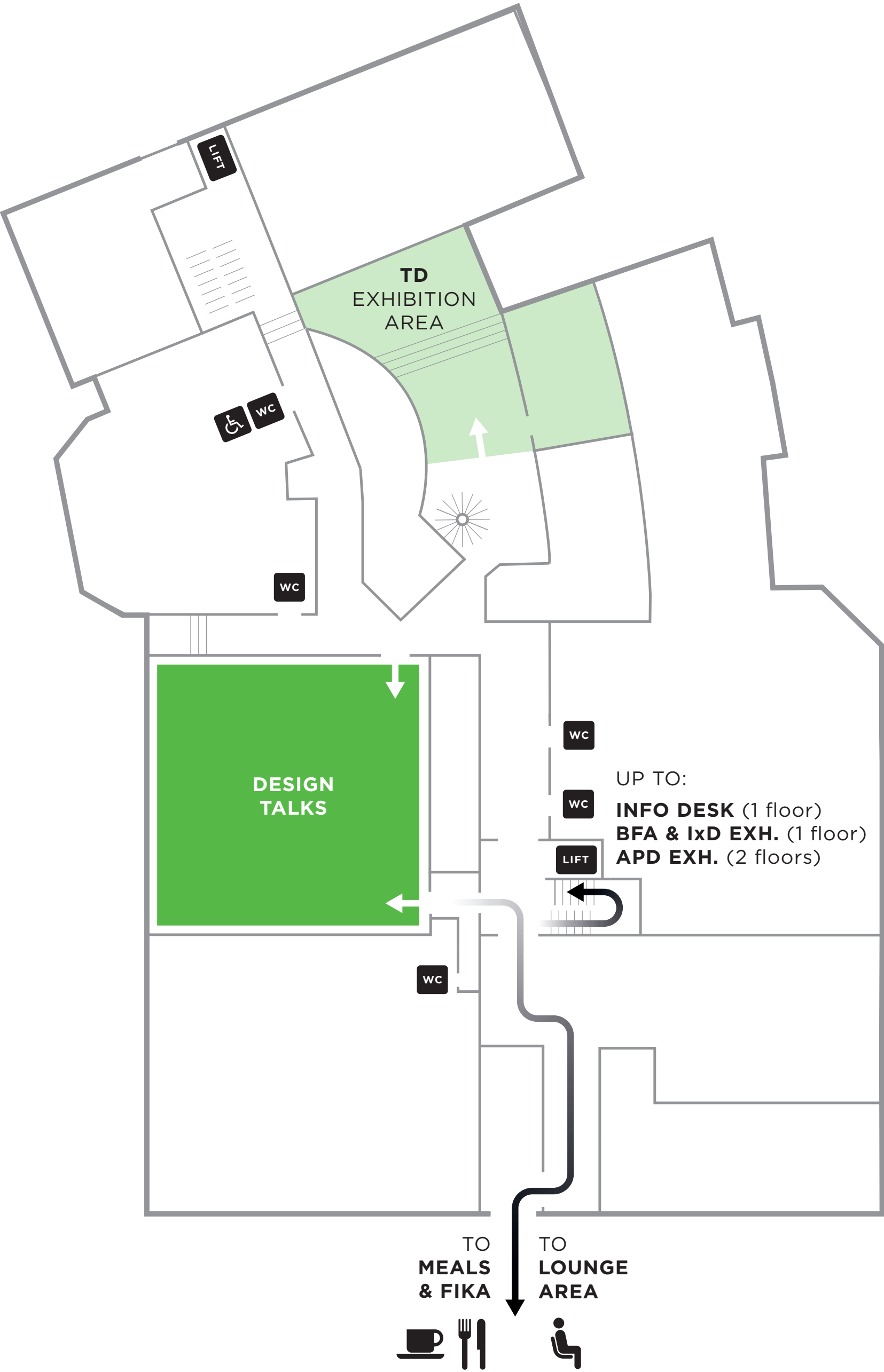

Finding your way around UID

Top Floor (1)

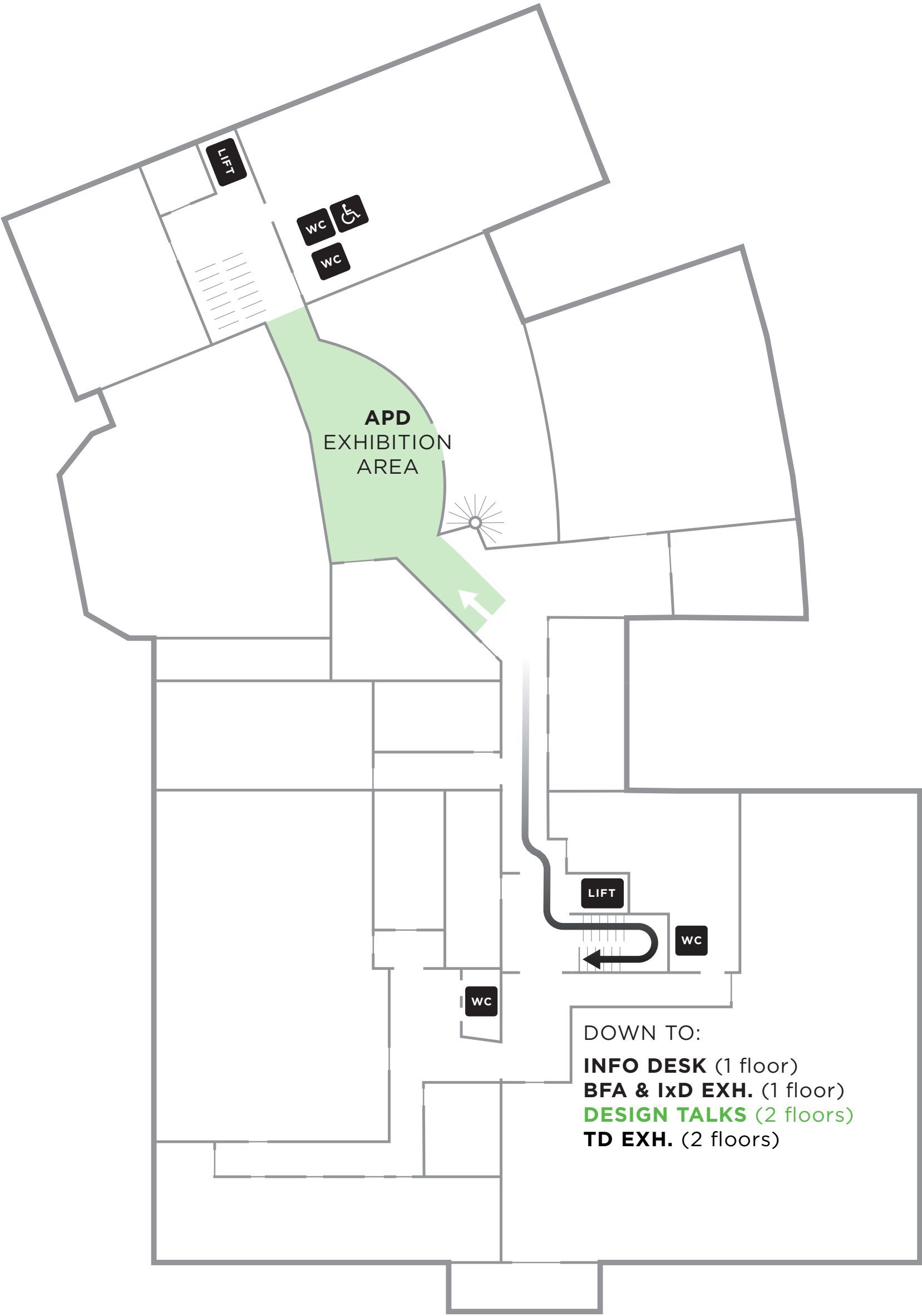

Practical Information

Contact details

The main point of contact is the **info/registration desk**.
Stop by if you need help with any issues that arise.

Umeå Institute of Design, Umeå University,
901 87 Umeå, Sweden, +46 90 786 69 96
www.uid.umu.se

Emergency

Call 112 for any kind of urgent emergency.
Call 1177 both for healthcare advice and for information
about the clinics to contact about your particular needs.

Taxi

Eco Taxi: +46 90 911 911
Flygtaxi: +46 8 120 920 00
Sverige Taxi Umeå: +46 90 100 100
Taxi 1A: +46 73 838 34 94
Taxi Björkstaden: +46 90 36 000
Taxi Kurir Umeå: +46 90 18 18 18
Umeå City Taxi: +46 90 10 01 10
Umeå MiljöTaxi: +46 90 12 12 12
Umeå Taxi: +46 90 77 00 00

Pick up address

Umeå Institute of Design
Östra Strandgatan 30
Umeå Arts Campus

Practical Information (continued)

Airport Bus (route 80)

The bus trip from Umeå city centre to Umeå Airport takes 8 minutes. During peak traffic periods, buses depart every 15 minutes.

Ticket price

Advance purchase SEK 60, purchase on board SEK 80.

Nearest airport bus stop

Vasaplan (Umeå city) which is a 12 minutes walk from UID.



Practical Information (continued)

UID23 website

<https://tinyurl.com/267sac2a>

Umeå Institute of Design website

www.uid.umu.se

Social media

Official hashtag: **#uid23**

Wifi

1. Choose **‘UmU wlan’**
2. Browse to **umu.se**
3. Login using:

User name: **Guest83899**

Password: **76nm5dnA**

NOTE: Abuse of the wireless network is not permitted.
All incidents will be reported and followed up.

Streaming

The UID23 broadcast offers a unique opportunity to get a glimpse into each student's individual design journey as they strive to make positive change through design. The show also includes interviews with our specially invited guests, followed by their individual keynote addresses. Recurring programme favourites such as the traditional signing of the ‘Wall of Fame’ and the announcement of this year’s ‘Golden Seed Award’ recipients will also be part of the programme.

Watch the broadcast: <https://tinyurl.com/4cuckah7>

UID23 Guests

258 Productions AB

Nigel Papworth

Aalborg University

Timothy Merritt

ABB AB - Robotics

Simon Hallstadius Linge

Above

Aaron Wansch

Viggo Blomqvist

Accenture Song (Fjord)

Ashutosh Biltharia

Luca Bottoni

AFRY Ark Studio

Tord Berggren

AFRY Experience Studios

Eva Lindgren

Karin Plonaitis

Markus Grip

Ruben Eriksson

Agile Robots AG

Fabian Wappler

Sebastian Aumer

Aina Nilsson Ström

Almedalsgolv

Eric Claesson

Marc Hoogendijk

Sara Szyber

Berge

Carl Berge

Ernst Hellby

Noel Thomas

Susanne Lidén

Beskow von Post

Caroline von Post

Susanne Beskow

BMW Group

Mario Kapsalis

Mario Schaffeld

Mattias Granlund

Tobias Adami

Tong-Tong Wang

Boom Supersonic

Chris Wright

Chalmers

Olle Wranne

Sanna Dahlman

changeworks.se

Alex Liebert

Katarina Johansson

Cliff Design

Anders Nordlund

David Wolter

John Samuelsson

Martin Lundquist

Coloplast

Ignacio Javier D'Avola

Kristoffer Zeuthen

Convatec

Jost Siebert

Danjel Bazhella**Daresay**

Fredrik Johansson

Linda Bresäter

Designit

Toby Whelan

DW

Yining Qian

E-hälsomyndigheten

Kristina Tarre Monfrino

Linus Ersson

Ericsson

Mansooreh Shahtalab

Mårten Skoger

eXpression Umeå

Barbro Renkel

EY Doberman

Lisa Lindström

FAB LAT

Beno Juarez

Ford Werke

Amko Leenarts

Gemla

Anton Mannervik

GTC

Henrik Otto

Gullers Grupp

Olof Malmberg

Henson

Jonas Pekkari

Sebastian Sahin

Huawei

Hugo Martinsson

Rowena Lee

Hultaforsgroup

Nicole Rimér

Ulrika Lindgren

Hyper Island

Agnes Zedig

Hyundai

Max Holstein

Victor Andrean

Indian Motorcycle/Polaris

Ola Stenegard

iveco

Marco Armigliato

Jabra

Jacob Jensen

Philip Bellham

Jaguar Land Rover

Christopher Duff

Luke Smith

Jens Peter Weinreich**Johan Sundberg Arkitektur**

Gudmund Bladh

Jönköping University

Lars Eriksson

Julian Loretz**Kivra**

Diana Africano Clark

Gustav Linzatti

Rachel Pardo

Knightec

Lotta Quist

Oskar Wembe

Kulturdepartementet

Jeanna Andreen

Laerdal Medical

Bram van Krieken

Connie Jehu

Hector Mejia

Ilteris Ilbasan

Wilma Lindbäck

Yuanzhen Cai

LEGO

Mike Kirk Andersen

Lies-Marie Hoffmann**Link Design and Development**

Paavo Mäkelä

Lisa Modin**McKinsey**

Erik Ceder

Malin Orebäck

Microsoft

Lene Rydningen
Shibashankar Sahoo

MOVS

Jonas Rundqvist

Myra part of Prevas

Jon-Karl Sundh
Philip Nilsson

Nils-Erik Gustafsson

NoA Ignite

Heidi Lisle
Selvi Olgac

Nokia

Jon Sommarström
Jonne Harju

Normal Object Factory

Chien-Kuang Liu

Noto

Julian Sommer

Orrefors Kosta Boda

David Carlson

PayPal

Johan Grönskog

Phocus Brand Contact

David Bertl

Plokk kommunikation

Ingemar Larsson

Propeller Design

Olle Gyllang

RISE

Albert Edman
Jeroen Peeters

Rotho Kunststoff

Lovisa Lund

Round Feather

Angela Tziafeta
Angeles Abarca
Belén Martinez

Skellefteå Science City

Emina Kovacevic

Slow Food Sapmi

Ellacarin Blind

Sms Evoko Group

Joel Grundström

Socialstyrelsen

Agneta Calleberg
Nina Nikkilä

Sweco

Emelie Sjöström

Södersjukhuset

Baptiste Guesnon
Clara Chague
Elin Hedbrandh
Josefin Vargö
Pomme van Hoof

Stokke

Marius Kindler

Studio Caro Lundin

Caro Lundin

Svensk Form

Mats Widbom
Niklas Arnegren

SVID

Jonas Olsson
Pia Mcaleenan

Swedbank

Ru Zarin

Swedish Institute

Jenny Bergström Bonmot

THULE

Daniel Åhman
Sinan Altun

Topia

Amid Moradganjeh
Erik von Konow
Lotta Sahlin

Umeå Kommun

Agneta Filén
Anna Olofsson
Peter Juneblad
Susanne Thurén

Umeå University

Dide Sevincok
Erik Domellöf
James Benedict Brown
Mattias Pettersson
Teresa Almeida

Victor Hillebjörk

Viktoria Melinder

Volvo Group Trucks Tech.

Jonathan Disley

Zeekr - Geely Design

Henrik Erbéus
Ignacio Fernandez Mino
Lars Falk
Robin Wöhr

[illegible]

Did Did Did Did

A vertical bar chart consisting of 10 segments. Each segment is a solid black rectangle with a white capital letter 'I' centered within it. The segments are stacked vertically, separated by thin white gaps. The 'I' characters are uniform in size and position across all segments.